

**AFFORDABLE - TIMBERLOOK BI-FOLD ORDER**Page  of 

Customer \_\_\_\_\_  
 Address \_\_\_\_\_  
 \_\_\_\_\_  
 Tel No \_\_\_\_\_  
 Email/Fax \_\_\_\_\_  
 Post Code \_\_\_\_\_ Job Reference \_\_\_\_\_  
 Contact \_\_\_\_\_ Quote Date \_\_\_\_\_

Goods £   
 VAT £   
 Total £

Order Date \_\_\_\_\_  
 Customer Signature \_\_\_\_\_  
(By Signing this order you agree to Affordable Window Systems Ltd. Terms & Conditions)

Date Req. (ALSO INVOICE DATE)

PRODUCTION CODE:

DELIVERY CODE:

**GLASS**  
 Tripleshield  Stay Cool  Unglazed

**WARM EDGE**  
 Black   
 White

**HANDLES**  
 White  Silver (Satin)  Gold (Bright)   
 Black  Silver (Bright)

White PVCu   
 Rosewood ON BROWN  Oak ON CAMEL   
**ALL COLOURS BOTH SIDES BELOW ARE ON WHITE**  
 Black  Fir Green  Antique Pine   
 Grey  Chartwell Green  (Irish Oak)  
 Cream  Polar White Foil  PLEASE NOTE: The base profile is on white

**COLOUR OUTSIDE ONLY**  
 Oak on White  Fir Green on White  Rosewood on White   
 Cream on White  Polar White Foil  Chartwell Green on White   
 Black on White  on White  
 Grey on White  Antique Pine on White   
 (Irish Oak)

        	<b>All diagrams are OUTSIDE VIEW ONLY</b> <b>Stack In <input type="checkbox"/> Stack Out <input type="checkbox"/></b> <b>Item Qty</b> <b>Location</b> <b>Width</b> <b>Height</b> <b>Cill</b> None <input type="checkbox"/> Clip on Cill <input type="checkbox"/> <b>Trickle Vent</b> No <input type="checkbox"/> Yes <input type="checkbox"/> <small>In 42mm Knock On only, show position on diagram</small> <b>*NEW* Tilt &amp; Lift Blinds</b> Yes <input type="checkbox"/> <b>Colour</b> <b>Notes:</b>  <b>* On Slimline French Doors, Master Door will have a Lever/Lever handle and the slave will have a D-Pad to inside only</b>	      
----------------------------------	--	--------------------------

**Sightlines:**  
 132mm - Sliders/Slider  
 160mm - Traffic/Traffic  
 222mm - Slider/Traffic

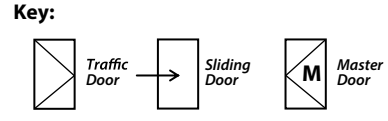

A traffic door has a conventional lever/lever locking handle, allowing one or two doors in the Bi-Fold door set to operate as a conventional back door. **The minimum size of a sash is 500mm and the maximum is 750mm. Frames marked (222) have a wider sightline where a traffic door meets a sliding door.**  
 \*Bi-folds over 4m will be sent out in kit form and require on site assembly.

# TIMBERLOOK SLIM-SASH PVC-u BI-FOLDING DOORS

## THRESHOLD OPTIONS

### OPTION 1.

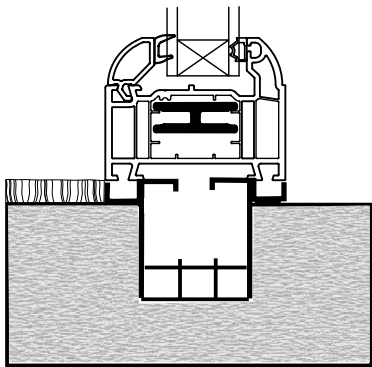

It is possible to recess the track 45mm into the floor

### OPTION 2.

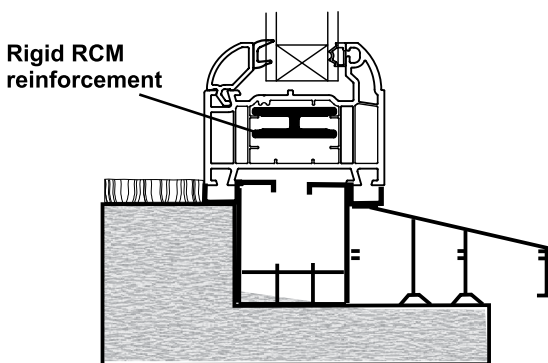

By lowering the external brickwork - the track can be installed flush with the internal floor

### OPTION 3.

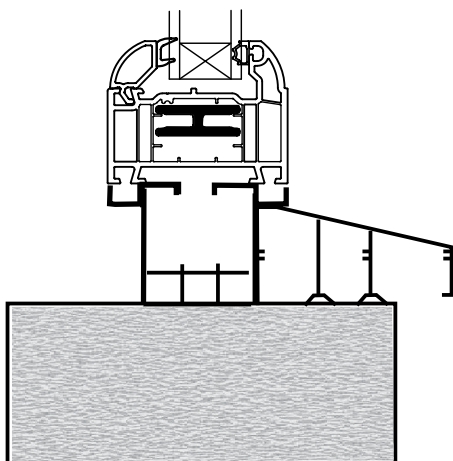

Fitted in the conventional way the upstand is only 52mm while conventional PVC-u Bi-Folding doors have an upstand between 100mm and 140mm

Timberlook Slim-Sash PVC-u Bi-Folding Doors have a sight line of 132mm sash to sash when doors slide to one side only.

This will double if doors are arranged to open both ways from the centre, however it is possible to have a traffic door one way and the other doors folding in the opposite direction and the sight line will only increase by 40mm where the doors meet.

The Bi-Fold doors can open in or out and are available up to 6 metres wide in any number of configurations.

The Timberlook 60mm sash has a combination of steel, aluminium and RCM reinforcement. The RCM is welded producing a weld strength which would normally require a much wider door sash.

The maximum sash width is 750mm and the minimum width is 500mm - the ideal width is 600mm to 650mm for optimal performance.

- The Timberlook Bi-Fold aluminium thresher is 52mm high.
- The Threshold can be fitted flush to the inside and outside floor and is also available with an external aluminium sill that does not increase the threshold height of 52mm.
- The rollers are concealed and are resistant to attack from potential intruders
- Hardened steel hook locks, dead bolts and top/bottom shootbolts are specified for high security and flat handles minimise stacking space when opened.
- The wheels which are stainless steel operate quietly and smoothly and have sealed bearings for maintenance free use.
- There are 4 expansion seals between each door.

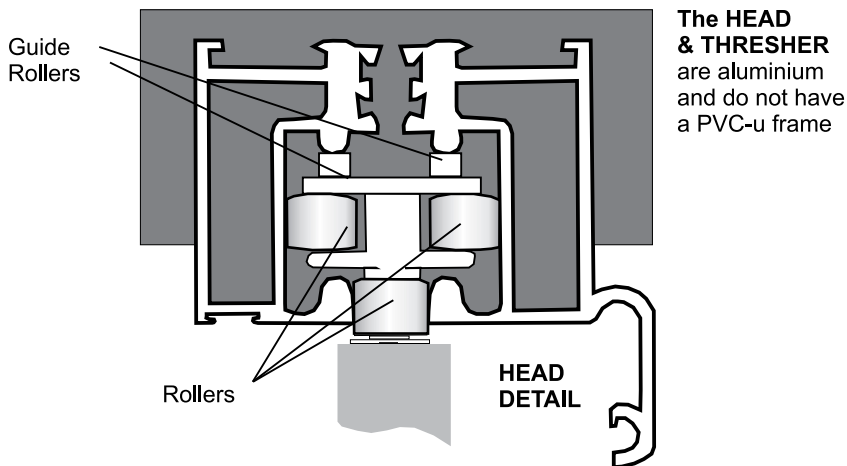

The Aluminium Head & Thresher encapsulate the running gear so that the door cannot be lifted from the track.